

## concrete building blocks

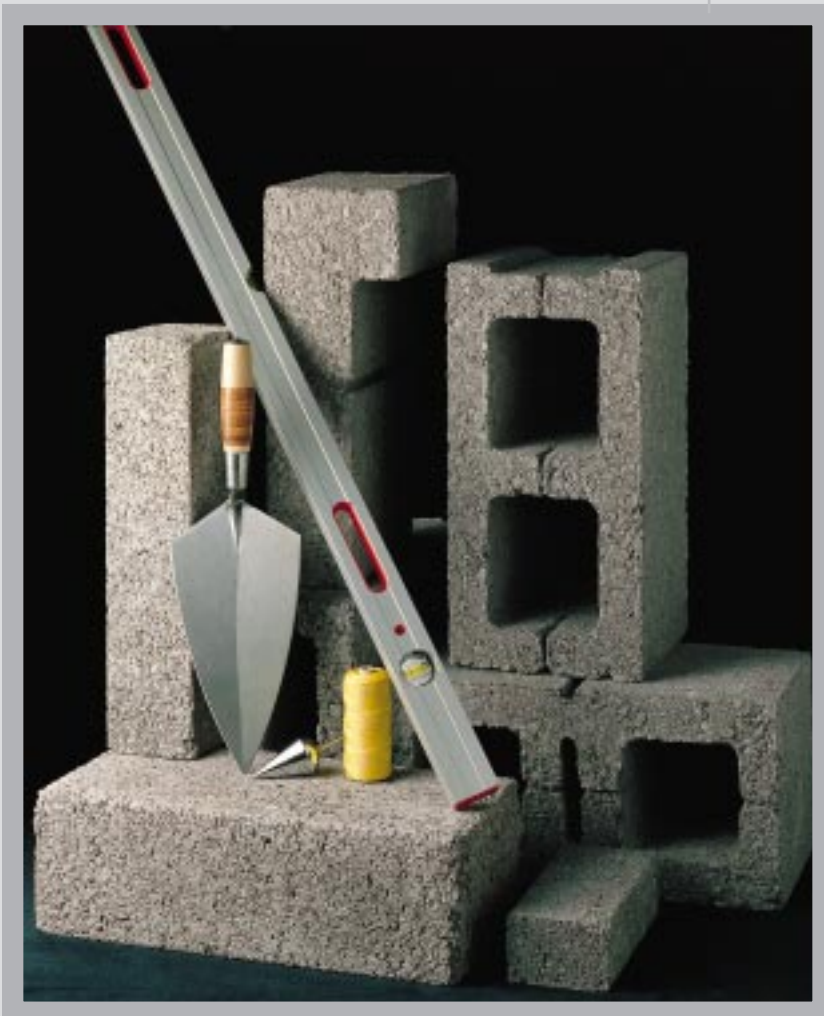

Roadstone is the single largest producer of concrete blocks in Ireland. Manufactured in two ranges with a choice of standard or fine textured finish, they comply with the Irish Standard Specification IS 20:1987 and NSAI quality management system IS EN ISO 9002.

In addition, Roadstone manufactures High Strength Blocks to meet the requirements detailed in IS 20:1987.

Roadstone concrete blocks are manufactured from aggregates specially produced at our own quarries. This reliability of raw materials together with consistency of manufacture, stringent quality control procedures, secure banding and mechanical handling, all contribute to the delivery of a quality product.

As a market leader we are focused on customer service, product innovation, manufacturing expertise and technical support and we are pleased to advise on any special products and requirements.

## 400 range

Co-ordinating size 400mm x 200mm - 12.5 blocks per sq. metre.

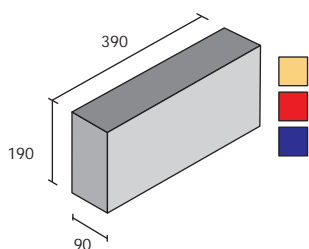

**Solid**  
390 x 190 x 90mm  
13kg. 5MPa (5N/mm<sup>2</sup>)

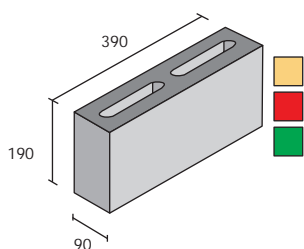

**Hollow**  
390 x 190 x 90mm  
11kg. 5MPa (5N/mm<sup>2</sup>)

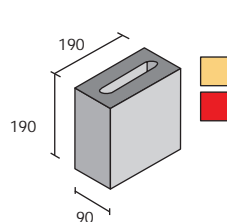

**Half Hollow**  
190 x 190 x 90mm  
6kg. 5MPa (5N/mm<sup>2</sup>)

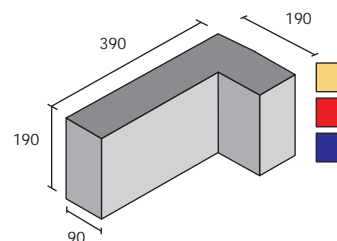

**Quoin/Cavity Closer**  
390 x 190 x 90/190mm  
17kg. 5MPa (5N/mm<sup>2</sup>)

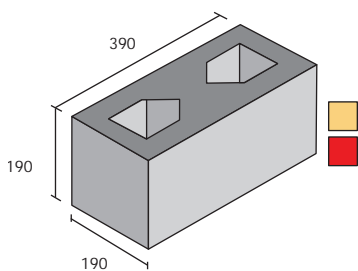

**Hollow (25% Void)**  
390 x 190 x 190mm  
25kg. 5MPa (5N/mm<sup>2</sup>)

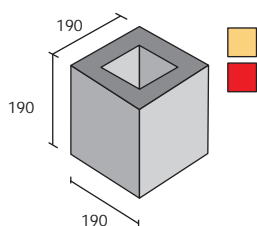

**Half Hollow (25% Void)**  
190 x 190 x 190mm  
13kg. 5MPa (5N/mm<sup>2</sup>)

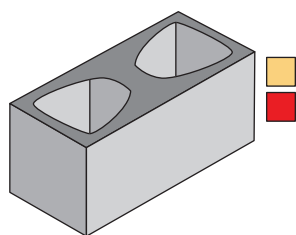

**Hollow**  
390 x 190 x 190mm  
18kg. 3MPa (3N/mm<sup>2</sup>)

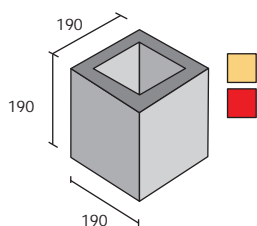

**Half Hollow**  
190 x 190 x 190mm  
9kg. 3MPa (5N/mm<sup>2</sup>)

- Standard Block
- To order only
- Also manufactured in Fine Texture
- High strength available

# concrete building blocks

## 450 range

Co-ordinating size 450mm x 225mm - 9.88 blocks per sq. metre.

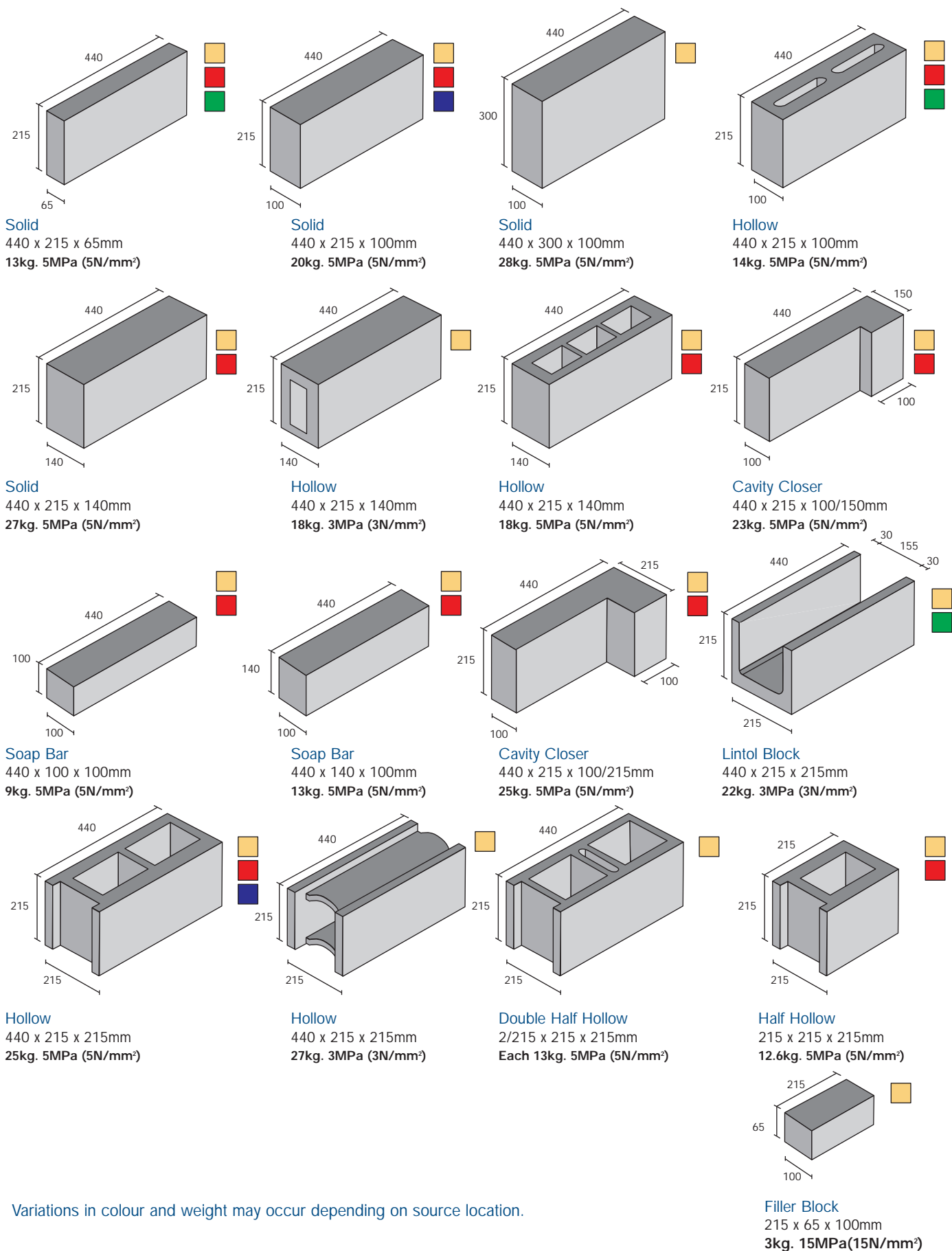

Variations in colour and weight may occur depending on source location.

Concrete Blocks, Readymixed Concrete, Macadam and Asphalt, Grolime, Stonefill and Road Chips, Sand and Aggregates, Roof Tiles and Clay Bricks, Mortars and Dashing, Paving and Silica Sand.

Specialist Contractors for Macadam, Asphalt and Paviers.

Roadstone Provinces Ltd., Head Office, Saggart, Co. Dublin.  
Telephone 01-404 1400 Fax 01-404 1404 www.roadstone.ie

#### North East Region Block Plants

	Phone	Fax
Castleblayney, Co Monaghan	042 974 0026	042 974 6412
Slane, Co Meath	041 982 4214	041 982 4243
<b>Regional Office</b>		
Drogheda, Co Louth	041 983 7764	041 983 5011

#### North West Region Block Plants

Athlone, Co Roscommon	0902 92731	0902 92369
Castlebar, Co Mayo	094 21266	094 23348
Galway, Co Galway	091 709050	091 752199
Castlemine, Co Roscommon	0903 29511	0903 29521
Boyle, Co Roscommon	079 62057	079 62059
Ballintra, Co Donegal	073 34022	073 34203
<b>Regional Office</b>		
Two Mile Ditch, Galway	091 709060	091 752199

#### South West Region Block Plants

Ballyneety, Co Limerick	061 351253	061 351003
Holycross, Co Tipperary	0504 43219	0504 43163
Cahir, Co Tipperary	052 41333	052 42406
Bunratty, Co Clare	061 709500	061 709575
<b>Regional Office</b>		
Bunratty, Co Clare	061 709500	061 709555

#### South East Region Block Plants

Carrolls Cross, Co Waterford	051 294102	051 294521
Brownswood, Co Wexford	054 33455	054 35940
Arklow, Co Wicklow	0402 32016	0402 32018
Kilmacow, Co Kilkenny	051 895508	051 895405
<b>Regional Office</b>		
Kilmacow, Co Kilkenny	051 895249	051 895405



A company within the CRH Group

